

## Tow bar wiring kit with electronic module

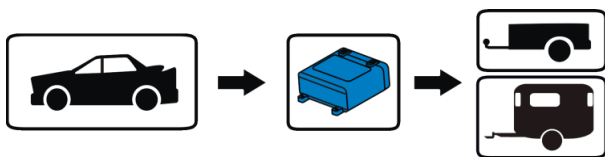

### Application:

- cargo trailers and caravans;
- 13-pin trailer socket.



### Short description:

The module does not overload the lamps driving system of the car as the current consumption from signal inputs is approximately 2 mA, which excludes the malfunction of the car electronics system.

Module can be connected to lamps both with LED diodes and light bulbs.





The WH2L-G13 module harness is designed to work with an additional trailer battery charging circuit. Such functionality is needed when connecting the caravan.

### Assembly kit content:

1. Electronic module;
2. Main harness;
3. Trailer 13-pin socket with seal and screws;
4. Montage kit.



### Main features:

-  **13** dedicated to 13-pin socket
-  compatible with vehicle lamps which have LED diodes or bulbs
-  **X** Vehicle fog light is not turned off
-  **H** reverse light control

Trailer tester available in company's offer gives possibility to simulate trailer wiring system and verify kit installation.

